

# Brass Cleanout Plugs

## 25628 SOUTHERN CODE, 700 SERIES - CORED SQUARE HEAD

SIZE CODE	NOMINAL SIZE	APPROX NET WT.	DIM. A	DIM. B	DIM. C
0150	1	0.09	9/16	5/16	7/16
0215	1-1/4	0.12	11/16	5/16	13/32
0295	1-1/2	0.18	3/4	5/16	3/8
0390	2	0.26	15/16	5/16	7/16
0520	2-1/2	0.37	1	5/16	7/16
0650	3	0.49	1-1/8	7/16	15/32
0780	3-1/2	0.62	1-1/8	3/8	1/2
0860	4	0.97	1-3/32	3/8	1/2
0950	4-1/2	1.05	1-1/8	3/8	1/2
0975	5	1.40	1-3/8	7/16	1/2
1075	5-1/2	1.81	1-3/8	1/2	5/8
1100	6	2.27	1-3/8	1/2	5/8
1225	8	3.58	1-3/8	1/2	11/16

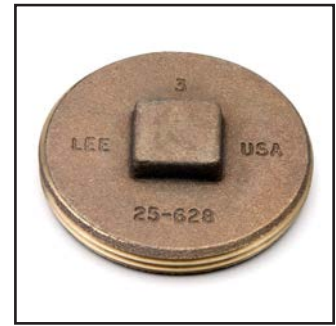
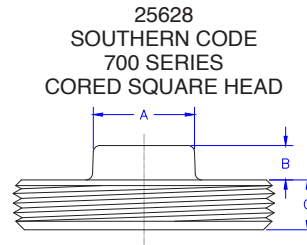

## 25629 SOUTHERN CODE, 700 SERIES - COUNTERSUNK

SIZE CODE	NOMINAL SIZE	APPROX NET WT.	DIM. A	DIM. B	DIM. C
0150	1	0.13	7/16	9/16	5/16
0215	1-1/4	0.21	13/32	5/8	5/16
0295	1-1/2	0.19	3/8	11/16	5/16
0390	2	0.26	7/16	3/4	5/16
0520	2-1/2	0.32	7/16	3/4	5/16
0650	3	0.46	15/32	7/8	5/16
0780	3-1/2	0.77	1/2	15/16	3/4
0860	4	0.95	1/2	7/8	3/8
0950	4-1/2	0.97	1/2	7/8	3/8
0975	5	1.72	1/2	1-1/8	3/8
1075	5-1/2	1.75	17/32	1	7/16
1100	6	2.06	5/8	1-7/16	1/2
1225	8	4.78	11/16	1-7/16	9/16

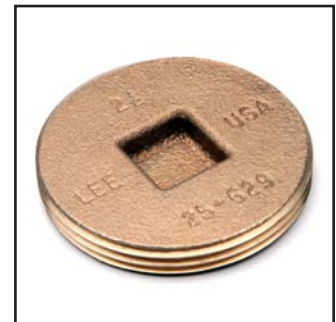
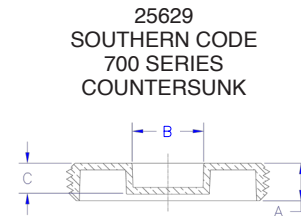

# Brass Cleanout Plugs

## 25620 OHIO CODE, 100 SERIES - CORED HEX HEAD

SIZE CODE	NOMINAL SIZE	APPROX NET WT.	DIM. A	DIM. B	DIM. C
0295	1-1/2	0.40	1	1	5/8
0390	2	0.43	1-1/4	1	3/4
0520	2-1/2	0.49	1-3/8	1	3/4
0650	3	0.67	1-3/8	1	3/4
0780	3-1/2	1.04	1-3/8	1	3/4
0860	4	1.27	1-3/8	1	3/4
0975	5	1.34	1-1/2	1	3/4
1075	5-1/2	1.74	1-1/2	1	3/4
1100	6	2.30	1-7/16	1	3/4
1225	8	3.95	1-3/4	1	3/4
1300	10	9.93	2-7/16	1	1-1/8

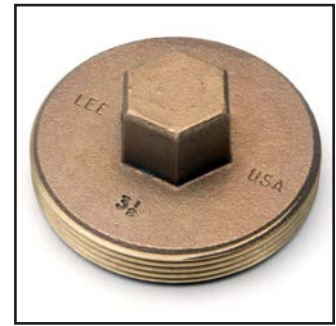
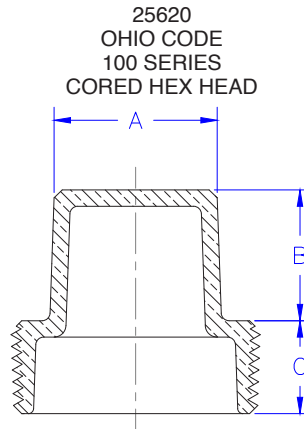

## 25632 LOS ANGELES UPC CODE, CORED SQUARE HEAD

SIZE CODE	NOMINAL SIZE	APPROX NET WT.	DIM. A	DIM. B	DIM. C
0390	2	0.42	1-1/4	5/8	3/4
0520	2-1/2	0.62	1-1/4	3/4	3/4
0650	3	1.09	1-5/8	3/4	1
0780	3-1/2	1.32	1-5/8	3/4	1
0860	4	1.75	2	7/8	1
0975	5	3.23	2-3/8	1	1
1100	6	4.00	2-3/8	1	1

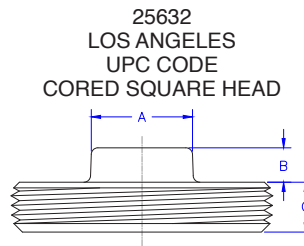

## 25633 LOS ANGELES UPC CODE, COUNTERSUNK

SIZE CODE	NOMINAL SIZE	APPROX NET WT.	DIM. A	DIM. B	DIM. C
0390	2	0.40	15/16	5/8	1/2
0520	2-1/2	0.63	15/16	3/4	5/8
0650	3	0.92	1-7/32	3/4	5/8
0780	3-1/2	1.26	1-7/32	3/4	1/2
0860	4	1.74	1-17/32	7/8	11/16
0975	5	2.90	2-1/32	1	3/4
1100	6	3.80	2-1/32	1	3/4

